

SmartThings

1.

To connect with **Samsung's SmartThings**, choose the option to Import rooms and select **SmartThings**. You will be redirected to the **Samsung Account** page.

See the [list of smarthome providers](#) in **detailed project setup**, to check which ones are supported

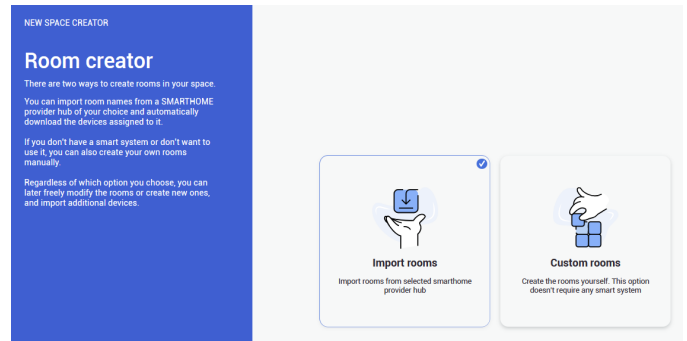

2.

On the **Samsung's Account** page you will be asked to log into your **Samsung Account**, to proceed.

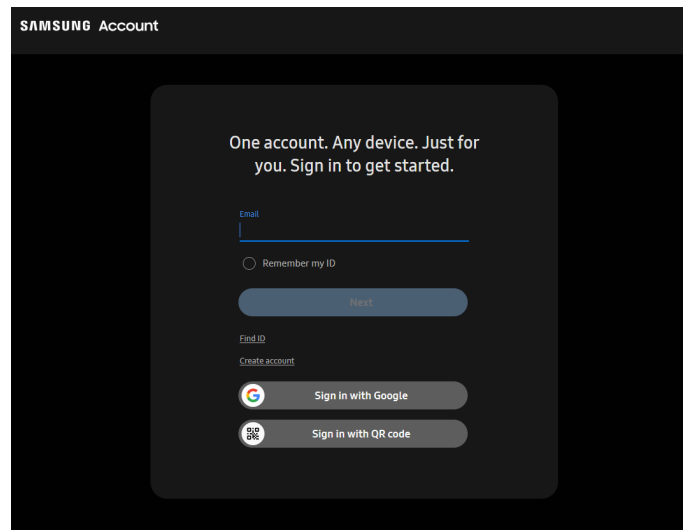

3.

After you log in, you need to allow access for **SIM-ON** to connect to the system. In the dropdown window you will see all of the available, connected hubs.

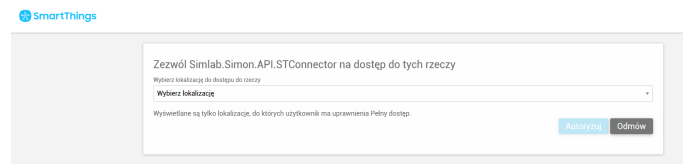

4.

After choosing the hub, you need to set all the privileges to authorize the connection.

Repeat these two steps (3,4) to add multiple hubs.

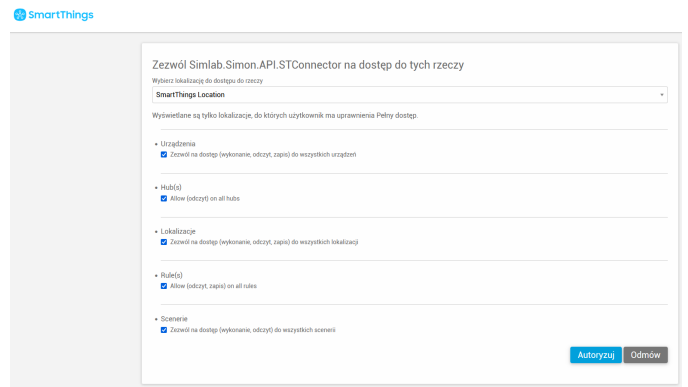

5.

After completing **Authorization**, you need to go back to the **SIM-ON** tab and the hub(s) you added will be now available.

Now you can add room(s) from the hub for the project.

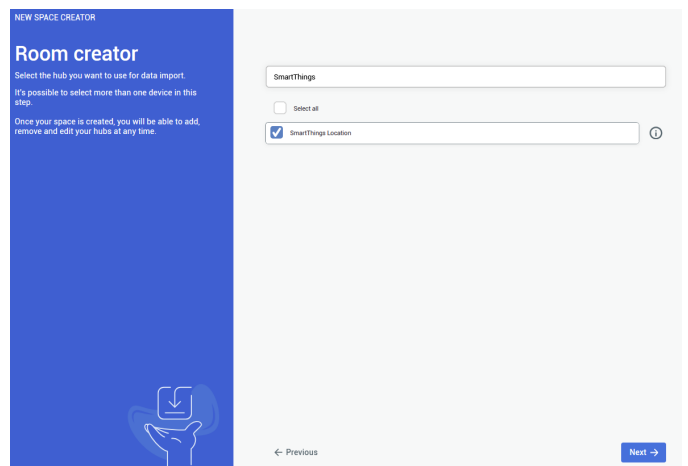

6.

Here you will be presented with the list of already existing rooms in your **SmartThings** hub. Choose any number of the rooms to be imported to **SIM-ON** then proceed.

You are not required to import any of the rooms, although it is recommended - to keep the consistency between smarthome environments

Rooms can be added and edited afterwards as well

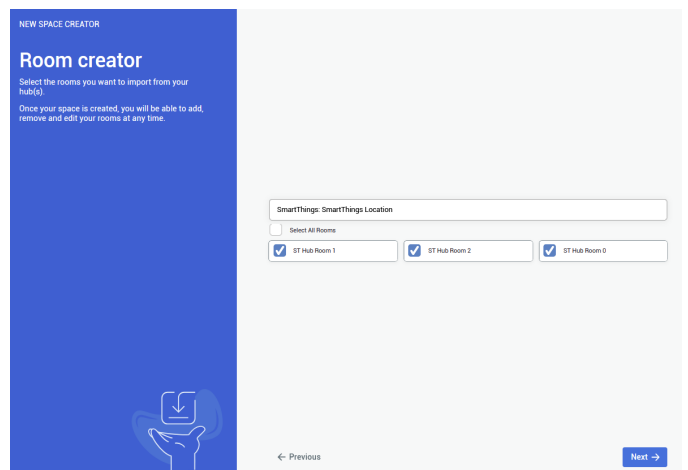

7.

The last step is to choose the **Matterport virtual tour** for the project to be used, through the provided **Matterport link**.

To use a **private link** you will be asked to **log in** to appropriate **Matterport Account**

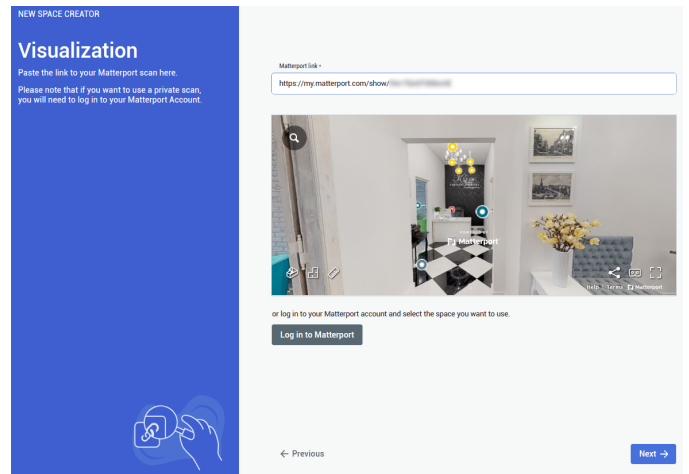

8.

Congratulations!

You've successfully imported the devices from **Samsung SmartThings**. By clicking confirm, you will see your space with an access to all of the devices.

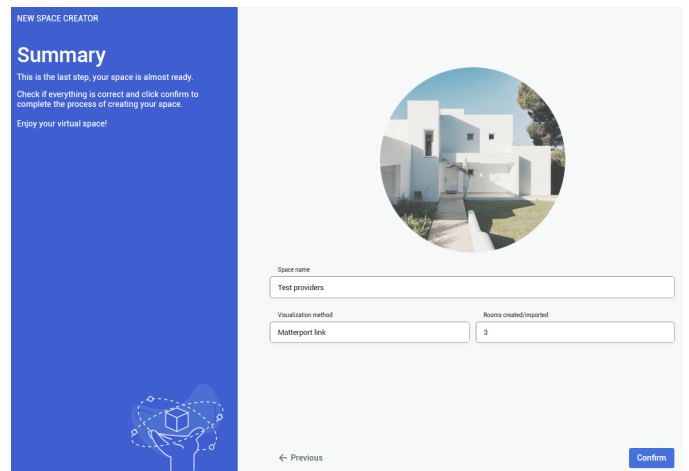

[Continue to project setup](#)

You can add a provider by selecting Providers in the side bar, and then clicking on **Add connections** button. The process will look exactly the same

You can also delete a connection by clicking on **Remove connections** button. Devices imported from the selected hub will be also deleted

Revision #36

Created 19 August 2024 11:02:39 by ewa.wierbik

Updated 12 December 2024 10:26:08 by JJanickiSIMLAB